

 THE EXTRA CLASS

MALIBU MOTORHOMES 2023

A-CLASS / COACHBUILT



**malibu**
a company of carthago

The brand with real added value	Page 3
The extra class: impressive quality	Page 5
 Malibu model range	 Page 6
Compact Class / Comfort Plus Class	Page 9
Malibu A-Class	Page 10
Malibu coachbuilt	Page 12
 Malibu motorhomes A-Class and coachbuilt in detail	
Living area	Page 14
Kitchen	Page 18
Washroom and changing room	Page 22
Sleeping area	Page 28
 The Malibu added value promise	Page 32
Top class bodywork	Page 34
Heating and air conditioning technology	Page 36
Most storage space in its class	Page 38
Pedelec scooter garage	Page 42
High quality furniture construction with Double connection technology	Page 44
Driver's cabin visibility concept	Page 46
 Malibu interior & exterior	
Worlds of living	Page 47
World of style and alloy wheels	Page 48
 Malibu test & rent – Enjoy a test drive	Page 49

WWW.MALIBU-MOTORHOMES.COM

There's a lot more to say about our motorhomes than we can fit in the catalogue! We therefore provide a great deal of additional information, pictures and interactive displays on our web site. Get some inspiration and comfortably navigate through your dream Malibu from home or on the move! Simply scan the QR codes in the catalogue with the camera of your Smartphone or tablet, and let yourself be taken straight to the topic.



Facebook

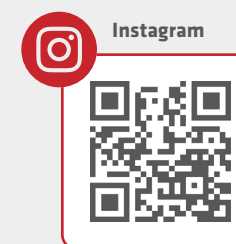

Instagram



YouTube



Newsletter



Patents – leading by means of innovation!

Patents are model-specific and country-specific,
The designations can differ.

FROM THE BEST SOURCE – THE BRAND WITH REAL ADDED VALUE

The first Malibu models which Carthago founder Karl-Heinz Schuler built in 1979 were already of the highest quality standard. This heritage is just as noticeable today in our A-Class and coachbuilt motorhomes as our decades of experience in the premium segment. Looking for something special? If so, a Malibu motorhome from the extra class is just the right thing! The first impression that you get becomes increasingly clear the closer you look: so many well thought-out details, so much more of everything that makes travelling relaxing. Such as the double floor with huge storage compartment that is unique in this class, the

elaborate bodywork with elegant roof / side wall rounding or the high quality furniture construction with double connection technology. We invest more know-how, time and effort than other manufacturers in order to offer you more value, more functionality, more comfort, more storage space, and more feeling of well-being. The GENERATION M of Malibu motorhomes is setting more standards than ever in the upper class – always with the claim of being the best motorhomes in their class, in order to give you the best holiday moments of your life.

Headquarters of the Carthago Group in Aulendorf, Upper Swabia



Malibu A-Class | I 500 QB



A UNIQUE SUCCESS STORY



2013

Inauguration of Carthago City in Aulendorf, southern Germany, with a large showroom.



2018

Three new models complete our range of motorhomes: the single bed model I 441 LE, just 6.67 m in length, and the super-comfortable I/T 490 LE and I/T 500 QB models.



2022

The Malibu motorhomes are gaining momentum, and won the European Innovation Award in the “Overall Concept” category. The international service and dealer network is also being extended to around 100 dealers in Europe.



2015

Exclusive presentation at the Caravan Salon Düsseldorf: the new A-Class and coachbuilt motorhomes were impressive! Voted New Product of the Year by AutoBild Reisemobil magazine.



2021

Launch of Malibu GENERATION M. All Malibu motorhomes now stand out with a new look, and impress both inside and out. State of the art top class technology, elaborate habitation construction, thermal bridge free roof/wall connection thanks to frame members glued over their entire surface, combined with a fresh design and high quality furniture construction.



IMPRESSIVE MALIBU QUALITY!

”

“Luxury reinterpreted: uncompromising comfort – that is what Malibu vehicles are known for. The compact I 441 LE provides a great deal of living space, impressive workmanship and brilliant detail solutions – and is still compact enough to casually cruise around idyllic country roads.”

”

AutoBild Reisemobil, 03/2022 | Test: Malibu I 441 LE

”

“The coachbuilt vehicle impresses across the board with comfortable beds and a spacious room concept. [...] Sometimes everything is simply just wonderful. Wonderfully comfortable, wonderfully designed, wonderfully cosy.”

”

AutoBild Reisemobil, 10/2021 | Endurance Test: Malibu T 430 LE

”

“That was impressive. Malibu has proven itself to be a comfortable and quality year-round motorhome. Its concept is well thought-out and designed to be extremely user-friendly.”

”

AutoBild Reisemobil, 05/2022 | Endurance Test: Malibu T 430 LE

”

“The Malibu I 490 LE is an absolutely top-of-the-line vehicle. [...] Everything is well thought-out and perfectly implemented. The vehicle is ideal for a holiday for four people.”

”

Kinder, Kinder, 10/2021 | Introduction: Malibu I 490 LE

”

“Outstanding driving comfort and a very relaxed living atmosphere are combined here. [...] The greatest praise from all of the testers was for the comfortable seating area with the easy-care upholstery.”

”

AutoBild Reisemobil, 03/2022 | Endurance Test: Malibu T 430 LE

”

“The Malibu I 441 LE appealed to the editors right from the start with its fresh styling, the successful room partitioning and the handy driving characteristics thanks to the short wheelbase. The new Fiat Ducato with the quiet engine and the rattle-free furniture construction make you look forward to long journeys in the A-Class motorhome.”

”

Reisemobil International, 04/2022 | Endurance Test: Malibu I 441 LE

”

“It is the right choice for anyone who is conscious of comfort and quality, and expects the best solutions down to the smallest detail. This starts at the front. Just like the A-Class motorhomes from Carthago, the large Malibu also has a splendid open view towards the front and onto the road directly in front of the vehicle.”

”

AutoBild Reisemobil, 05/2021 | Comparison Test: Malibu I 490 LE

MODEL RANGE, A-CLASS & COACHBUILT



A-Class (I)



Coachbuilt (T)



Right reserved to differences in the colour scheme or individual colour shades, differences in material characteristics and changes to the scope of delivery on the part of the manufacturer. This also applies to colour differences on basic vehicles, insofar as they are a result of changes made by the basic vehicle manufacturer.



Compact class with short vehicle lengths up to 6.95 m, also practical within the 3.5 t weight class

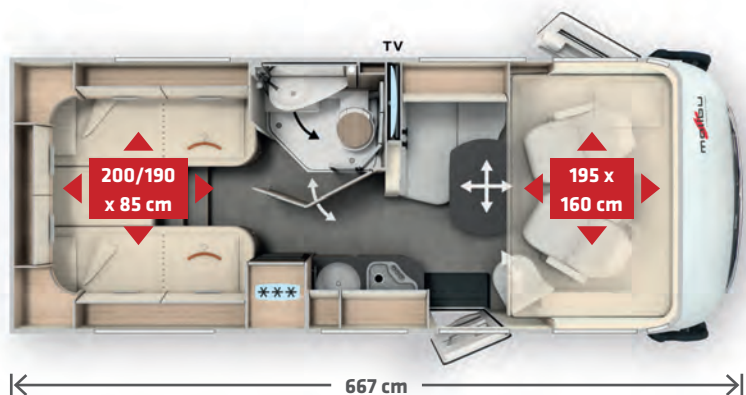

Currently only available as left-hand drive!



Malibu I 441 LE

	Vario swivelling washroom
	667 x 227 x 294 cm
	4
	4
	Large scooter garage, 120 cm
	2,965 kg
	1,245 kg

Model highlights:

- Short vehicle length of less than 7 m
- Innovative layout, specifically for the 3.5 t weight class
- L-shaped lounge seating area with swivel-out shoe cabinet and pull-out side seat
- Space-saving galley kitchen
- Private changing room
- Lengthways single beds with large sleeping area

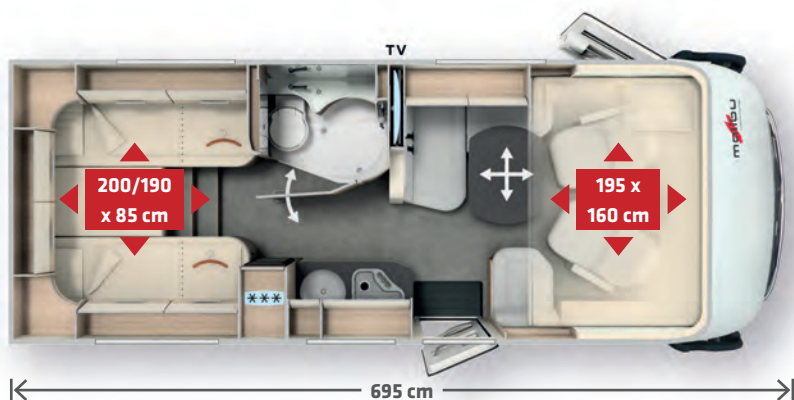

Malibu I 430 LE

Malibu T 430 LE

	Combined washroom	
	695 x 227 x 294 cm	690 x 227 x 294 cm
	4 / 5	2 / 3
	4	4
	Large scooter garage, 120 cm	
	3,035 kg	2,935 kg
	1,175 kg	1,275 kg

Model highlights:

- Short vehicle length of less than 7 m
- Comfortable layout with light weight
- L-shaped lounge seating area with swivel-out shoe cabinet and lift-up side seat bench
- LED flat screen TV (up to 32") at convenient viewing level incl. TV- pull out system***
- Space-saving galley kitchen
- Private changing room
- Lengthways single beds with large sleeping area



Washroom



Garage, interior height



Dimensions (L x W x H)



Weight in drivable condition from



Sleeping berths (standard / optional)



Payload up to



Seats with 3-point seat belt (standard / optional)

* 5th seat with 2-point seat belt (Malibu A-Class)

** with optional Pedelec scooter garage

*** optional

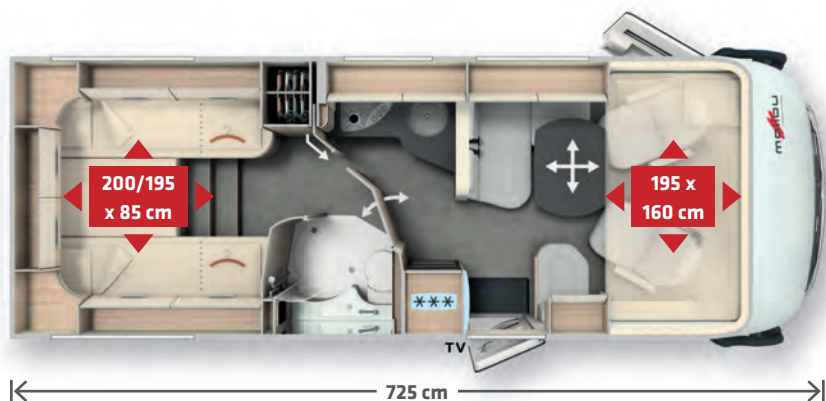

	Malibu I 460 LE	Malibu T 460 LE
	Combined washroom	
	725 x 227 x 294 cm	720 x 227 x 294 cm
	4 / 5	2 / 4
	4 / 5*	4
	Large scooter garage, 120 cm	
	3,085 kg	2,985 kg
	1,125 kg	1,225 kg

Model highlights:

- Comfort-oriented layout
- L-shaped lounge seating area with pull-out shoe storage and wide, swivel-up side seat bench
- Corner kitchen
- Private changing room / completely separable changing room***
- Floor-to-ceiling wardrobe
- Lengthways single beds with large sleeping area

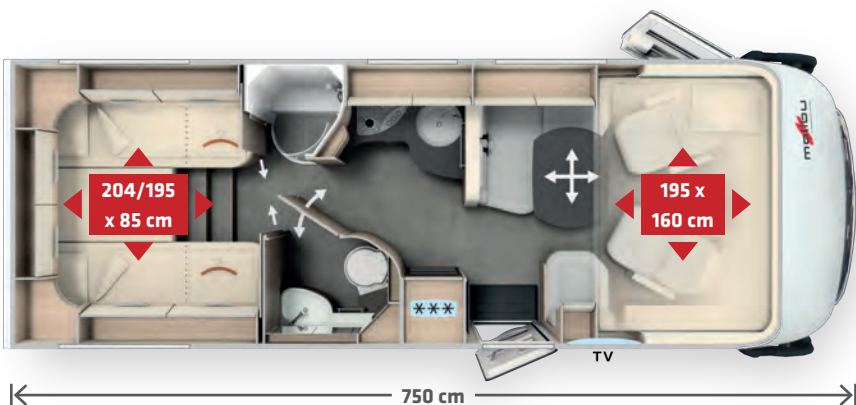

	Malibu I 490 LE	Malibu T 490 LE
	Comfort luxury washroom	
	750 x 227 x 294 cm	745 x 227 x 294 cm
	4 / 5	2 / 4
	4 / 5*	4
	Large scooter garage, 120 cm	
	3,100 kg	3,025 kg
	1,110 kg	1,185 kg

Model highlights:

- Comfort-oriented layout
- L-shaped lounge seating area with pull-out shoe storage and wide, swivel-up side seat bench
- TV pull-out system behind side seat bench for 32" LED flat screen TV (A-Class)***
- Comfort corner kitchen
- Completely separable changing room
- Lengthways single beds with large sleeping area

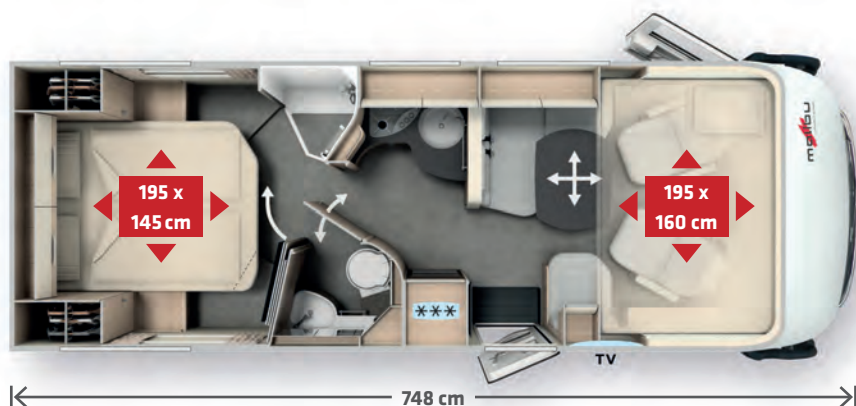

	Malibu I 500 QB	Malibu T 500 QB
	Comfort luxury washroom	
	748 x 227 x 294 cm	743 x 227 x 294 cm
	4 / 5	2 / 4
	4 / 5*	4
	Bicycle garage, 112 cm / 124 cm**	
	3,095 kg	3,025 kg
	1,115 kg	1,185 kg

Model highlights:

- Comfort-oriented layout
- L-shaped lounge seating area with pull-out shoe storage and wide, swivel-up side seat bench
- TV pull-out system behind side seat bench for 32" LED flat screen TV (A-Class)***
- Comfort corner kitchen
- Completely separable changing room
- Queen-size bed with large sleeping area



COMFORT CLASS

COMPACT AND LIGHT!

The compact class of Malibu motorhomes includes both coachbuilt and A-Class models. A common feature is the length of less than seven metres and the possibility of registration with a gross weight of 3.5 t. This means good handling while driving, and a motorhome which can be driven on a class B driver's licence. In spite of this, the compact class provides all of the distinctive characteristics of Malibu GENERATION M, and therefore complete motorhome comfort.

There's no doubt about it: Malibu – compact is class!

Malibu coachbuilt | T 430 LE



I 441 LE | London World of Living



COMFORT PLUS CLASS

THE DECISIVE PLUS!

Would you like a little more? More space, more equipment, more comfort – and all of this in an attractive body with enduring quality? If so, the answer is: Malibu Comfort Plus class. Nothing is left to be desired in the three coachbuilt and three A-Class motorhomes. They are up to a half metre longer than the biggest models in the Malibu compact class. Extra Space which makes a difference when 3.5 t certification is not essential, and comfort is more important than weight.

In a nutshell: Malibu Comfort Plus class – if you want a little bit more.

Malibu A-Class | I 490 LE



I 500 QB | Chestnut part leather world of living



Malibu Compact class:

- One coachbuilt and two A-Class from 6.67 to 6.95 m length
- Compact models suitable for 3.5 t certification
- Layouts with lengthways single beds
- Vario swivelling washroom or combined washroom
- Drop-down bed as standard in the A-Class models
- All of the technical and comfort characteristics of GENERATION M
- Optional: increase to 4.25 t permissible gross weight



Malibu Comfort Plus class:

- Three coachbuilt and A-Class from 7.20 to 7.50 m length
- Comfort Plus models outside the 3.5 t weight class
- Layouts with lengthways single beds or queen-size bed
- Combined washroom or comfort luxury washroom
- Drop-down bed as standard for the A-Class, optional for the coachbuilt
- All of the technical and comfort characteristics of GENERATION M

MALIBU A-CLASS

Malibu A-Class | I 490 LE

THE FASCINATION OF THE PREMIUM CLASS

Elegant exterior design, extraordinary feeling of spaciousness, panoramic views and top class driving feeling thanks to the unique Malibu driver's cabin visibility concept. Spacious living environment and an easily accessible drop-down bed – sweet dreams!

STANDARD EQUIPMENT:



Driving and visibility concept with best test values



XL habitation door "premium two 2.0"



Large L-shaped lounge seating area



Changing room



Double floor storage compartment



Underfloor heating effect

OPTIONS:



ALDE warm water heating (depending on model)



Omission of drop-down bed



32" LED flat screen TV (depending on model)



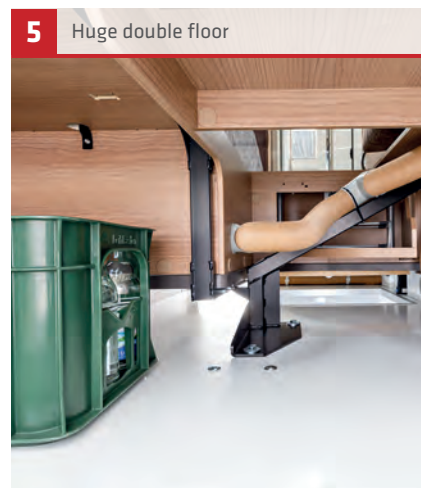

Strengths of the Malibu A-Class:

- 1** Active driving, extra-low dashboard for clear visibility of the road surface after just 2.77 m. Best test result! Three-dimensionally designed front, flat angle: less wind resistance, fuel consumption and wind noise
- 2** XL habitation door "premium two 2.0" with wider entrance size of 63 cm, secure double locking and extra-wide door window, blackout blind and integrated integrated flyscreen
- 3** Fuel tank flap integrated flush in the side panel
- 4** Driver's cabin door with extra-low entrance, secure double locking and electrically operated power windows
- 5** Huge storage compartment in double floor, accessible from the inside and the outside
- 6** Insulated pleated windscreen blind with vertical operation as sun blind, privacy screen, blackout and insulation from the heat and cold of the living area
- 7** Wiring for integrated reversing camera monitor in a glare-free location

MALIBU COACHBUILT

Malibu coachbuilt | T 460 LE

DYNAMIC WITH GOOD HANDLING

These are the stylish coupés among the motorhomes! The original driver's cabin is slim and gives you a hint of sportiness beneath the dynamic roof dome.

STANDARD EQUIPMENT:



XL habitation door "premium two 2.0"



Large L-shaped lounge seating area



Single level living area floor



Changing room



Double floor storage compartment



Underfloor heating effect

OPTIONS:



ALDE warm water heating (depending on model)



Central drop-down bed (depending on model)



"Skyview" skylight above driver's cabin



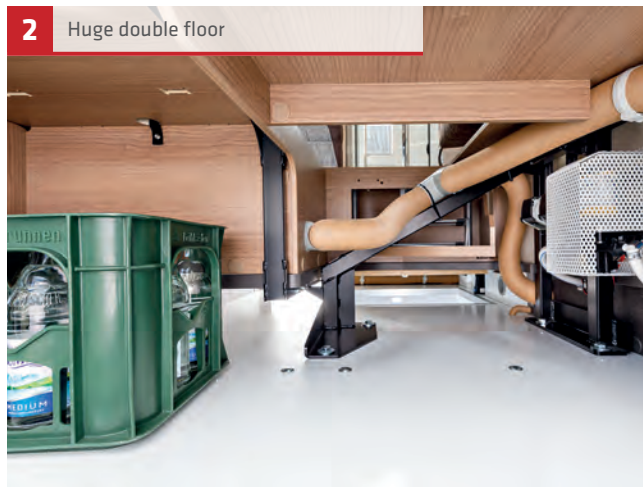

Strengths of the Malibu coachbuilt:

- 1 XL habitation door "premium two 2.0" with wider passage size of 63 cm, secure double locking and extra-wide door window, blackout blind and integrated integrated flyscreen
- 2 Huge storage compartment in double floor, accessible from the inside and the outside
- 3 Swivelling driver and passenger seats with upholstered armrests covered in same fabric as living area
- 4 Cosy atmosphere thanks to ceiling canopy with integrated, indirect lighting
Optional: "skyview" skylight with leather-covered designer headliner above driver's cabin and living area
- 5 Large, all-round overhead storage cabinets in driver's cabin, living area and sleeping area
- 6 Continuous one level living area floor, without tripping hazards

LIVING

Malibu A-Class | I 490 LE | Lisbon world of living





1 Swivel-out shoe cabinet



2 360° living area table can be rotated and moved in two directions using the foot pedal



3 All-round overhead storage cabinets above the lounge seating area (if drop-down bed is omitted)



4 LED main light and LED ambient lighting (can be switched on and off separately)

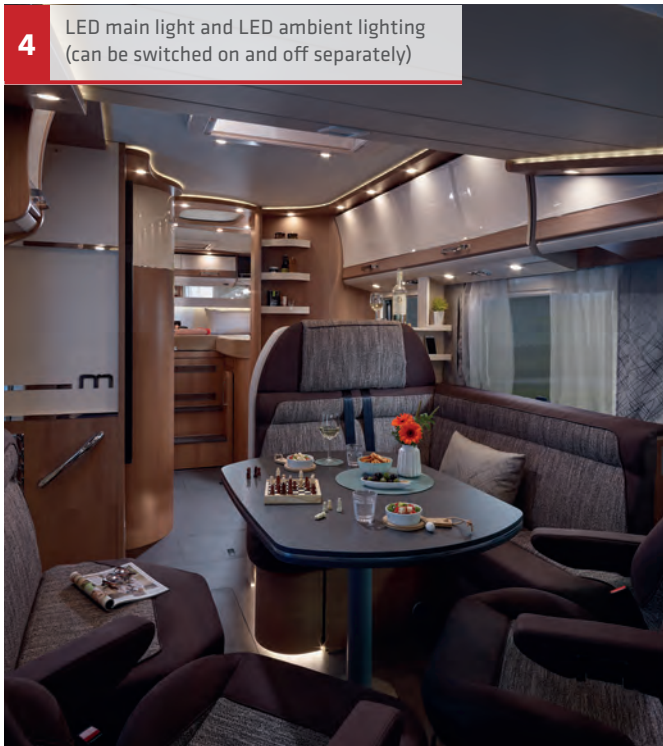

4 LED main light



4 LED ambient lighting



5 Elegant kitchen worktop



6 Optional: elegantly integrated designer TV cabinet incl. 32" LED flat screen TV | I/T 430 LE



6 Optional: "Quick up" TV pull-out system behind backrest of side seat bench | I/T 490 LE, 500 QB



Living advantages:

- 1 L-shaped lounge seating area with swivel-out shoe cabinet and holding system for up to four pairs of shoes integrated in the plinth of the seat bench, including LED mood light
- 2 360° living area table can be conveniently rotated and moved in two directions using the foot pedal
- 3 Plenty of storage space thanks to all-round overhead storage cabinets above the living lounge seating area (if drop-down bed is omitted)
- 4 Atmospheric living area lighting thanks to numerous LED spotlights integrated in the ceiling canopies and the drop-down bed area above the L-shaped lounge seating area; main light and ambient lighting can be controlled separately
- 5 Elegant kitchen work surface acts as visual room divider and additional storage area
- 6 Optional: LED flat screen TV (up to 32") at convenient viewing level incl. wall bracket or pull-out system*
- 7 Underfloor heating effect thanks to the fully heated double floor with climate storage function

* Position and/or size depending on model

GALLEY KITCHEN

(I 441 LE, I/T 430 LE)

1 Space-saving galley kitchen – for compact vehicle range



2 Lots of storage space thanks to six deep kitchen drawers



3 Multifunctional sink cover

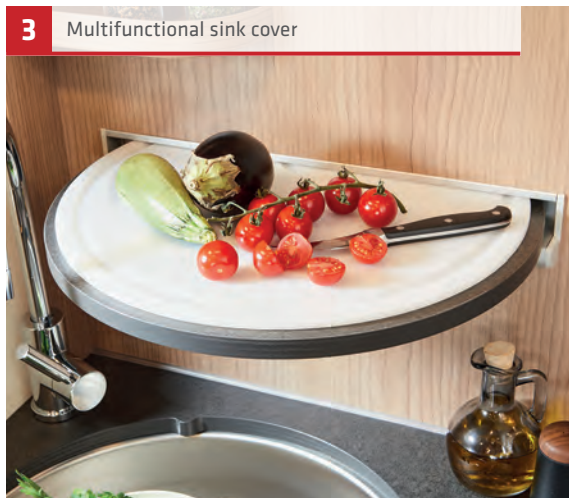

4 "Master Gourmet" 3-ring hob



5 133 I Slimtower fridge at convenient hand height



6 Spacious overhead storage cabinets



6 Optional: capsule coffee maker incl. pull-out system



Advantages of the galley kitchen:

- 1** Space-saving galley kitchen makes efficient use of available space
- 2** Lots of storage space thanks to six deep, roller-mounted kitchen drawers with self and soft closing mechanism and divided front panels for convenient access, plus integrated waste bin in separate hygiene area
- 3** Additional shelf created by inserting the sink cover into the wall holder
- 4** 3-ring gas hob with one-piece glass cover, removable cast iron trivet and easy-to-clean glass shelf
- 5** 133 I Slimtower fridge with separate 12 I freezer compartment with door opening at both sides, positioned at convenient hand height
- 6** Overhead storage cabinets with lots of storage space. Optional: capsule coffee maker including pull-out system in overhead storage cabinet
- 7** Flush work surface due to embedded round sink
- 8** Rear kitchen wall in cream decorative glass for easy cleaning and maintenance
- 9** Optional: gas oven with grill function in kitchen base unit

CORNER KITCHEN & COMFORT CORNER KITCHEN

(Corner kitchen: I/T 460 LE; Comfort corner kitchen: I/T 490 LE, 500 QB)

1 Comfort corner kitchen with curved, extra-large worktop and separate bottle cabinet | I/T 490 LE, 500 QB



1 Corner kitchen | I/T 460 LE



2 Large 153 l fridge | I/T 490 LE, 500 QB



3 Six deep kitchen drawers and bottle cabinet | I/T 490 LE, 500 QB



4 Separate pull-out waste bin

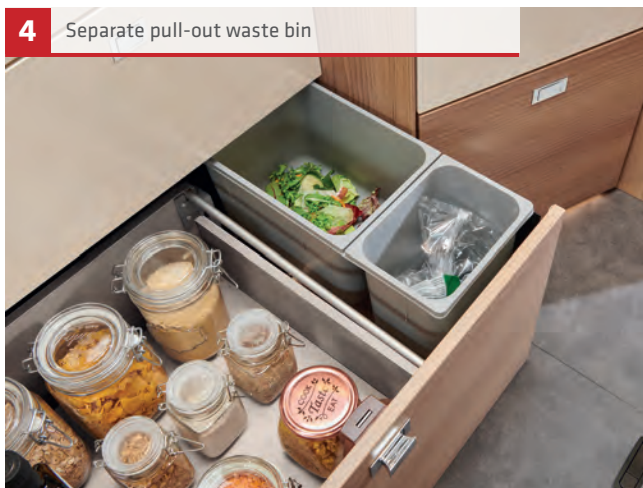

5 Optional: capsule coffee maker incl. pull-out system



Corner kitchen / luxury corner kitchen advantages:

- 1** Extra-large, flush work surface thanks to embedded round sink and additional storage surface created by hooking the sink cover into the wall holder
- 2** 133 l Slimtower or large 153 l fridge with door opening at both sides, positioned at convenient hand height
- 3** Lots of storage space thanks to six deep, roller-mounted kitchen drawers with self and soft closing mechanism and divided front panels for convenient access, plus wooden cutlery insert
- 4** Separate pull-out waste bins in separate hygiene area
- 5** Overhead storage cabinets with lots of storage space
Optional: capsule coffee maker including pull-out system in overhead storage cabinet
- 6** 3-ring gas hob with divided glass cover, removable cast iron trivet and easy-to-clean glass shelf
- 7** Elegant kitchen worktop for visual room partitioning and as additional storage surface
- 8** Elegant underlighting of kitchen work surface and floor lighting
- 9** Optional: gas oven with grill function in kitchen base unit

VARIO SWIVELLING WASHROOM WITH CHANGING ROOM

Vario swivelling washroom: washroom, toilet and shower room (I 441 LE)

1 Basic position: Large washroom and toilet



2 Swivelling wash stand mirrored wall



3 Large, completely separable shower room



3 Washroom remains dry while showering

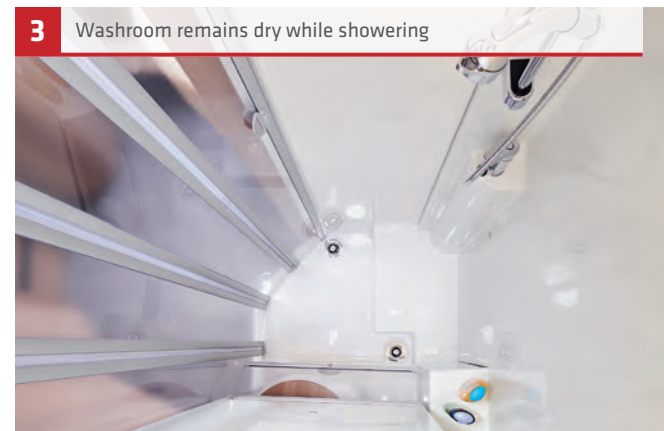

Vario swivelling washroom: changing room

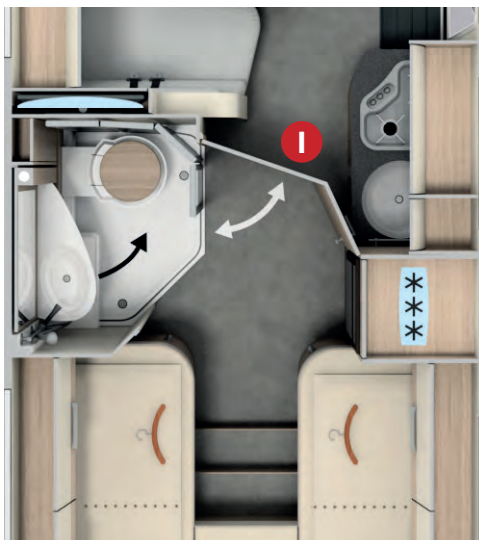

Model I 441 LE with lengthways single beds:
room partitioning and a changing room are created in a single step.

The washroom door ❶ acts as partitioning from the living and sleeping areas,
creating a private changing room at the same time.

4 Private changing area thanks to solid washroom door as a partition from the living area

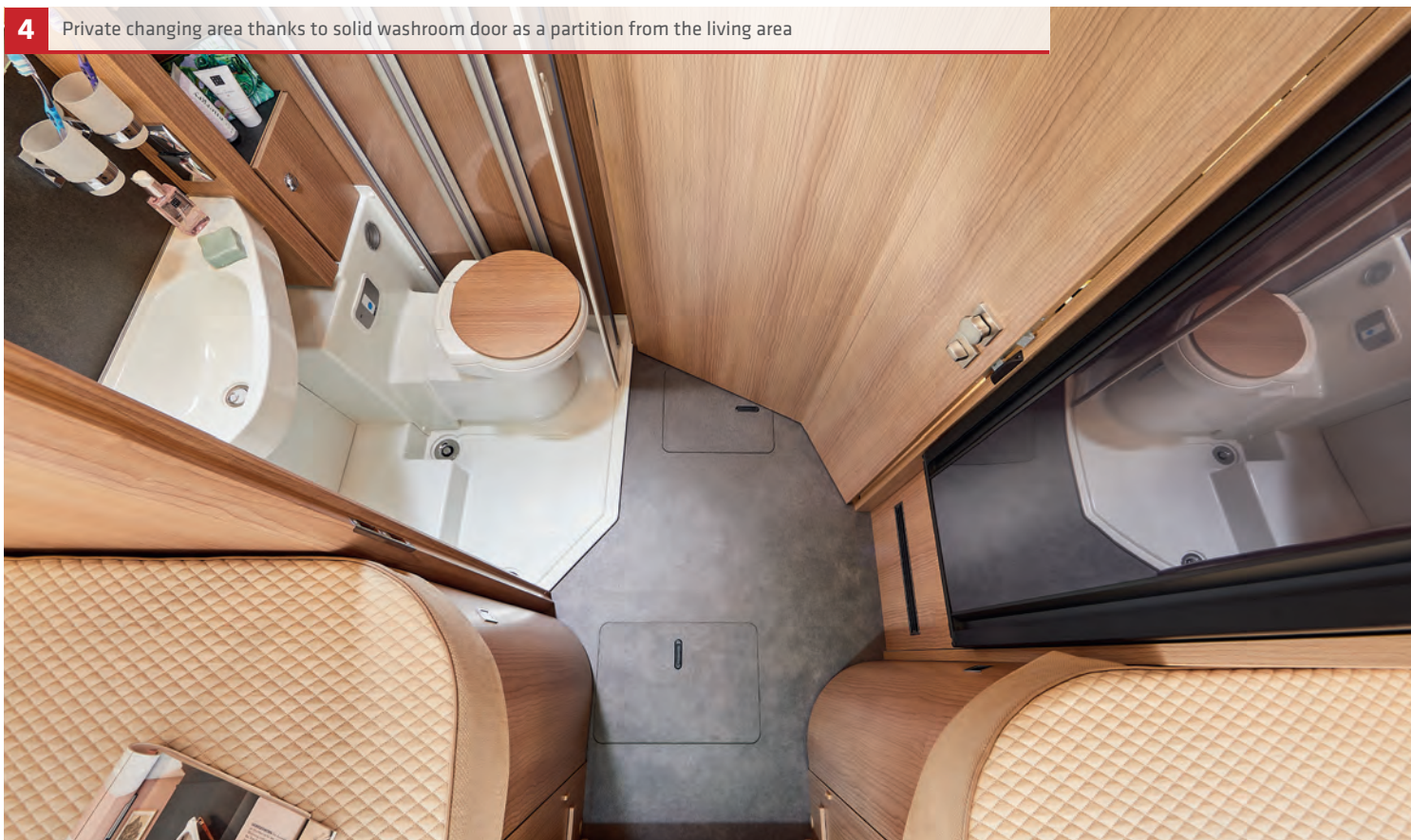

Advantages of the Vario swivelling washroom:

- 1 Well thought-out and innovative: clever use of space provides plenty of room and comfort with short vehicle lengths
- 2 Thanks to a sophisticated swivelling wall, a spacious shower or washroom / toilet is created in an instant
- 3 Large shower that can be separated off thanks to sectional shower door, washroom remains dry when showering
- 4 The washroom door acts as a partition from the living and sleeping areas, creating a private changing room at the same time
- 5 Shower tray with two drains and one-level floor
- 6 Many practical shelves, large utensil cabinet and mirror with backlighting
- 7 Plenty of light and ventilation in the washroom thanks to the Mini-Heki skylight

COMBINED WASHROOM WITH CHANGING ROOM

Combined washroom: washroom, toilet and shower room (I/T 430 LE, 460 LE)

1 The combined washroom has it all: washroom and toilet area, plus separable shower



2 Round shower with wrap-around doors – washroom stays completely dry when you take a shower



3 Spacious wash stand base unit



4 Large mirrored storage cabinet with shelving



Combined washroom: changing room



Model I/T 430 LE with lengthways single beds: room partitioning and a changing room are created in a single step.

The washroom door **I** acts as a partition from the living and sleeping areas, creating a private changing room at the same time.

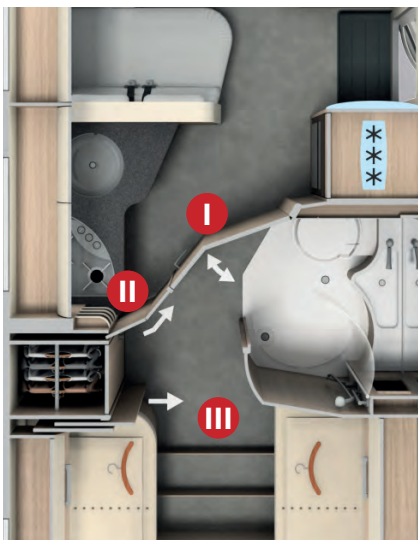

Model I/T 460 LE with lengthways single beds: room partitioning and a changing room that is separated from the living/sleeping area are created in just three steps.

The washroom door **I** and the pull-out room partition wall **II** also provide room partitioning from the living/sleeping areas and create a private changing room at the same time.

The optional, solid wood sliding door **III** in the sleeping area provides additional room partitioning and therefore a completely separate changing room.

5 Private changing area thanks to separable washroom door

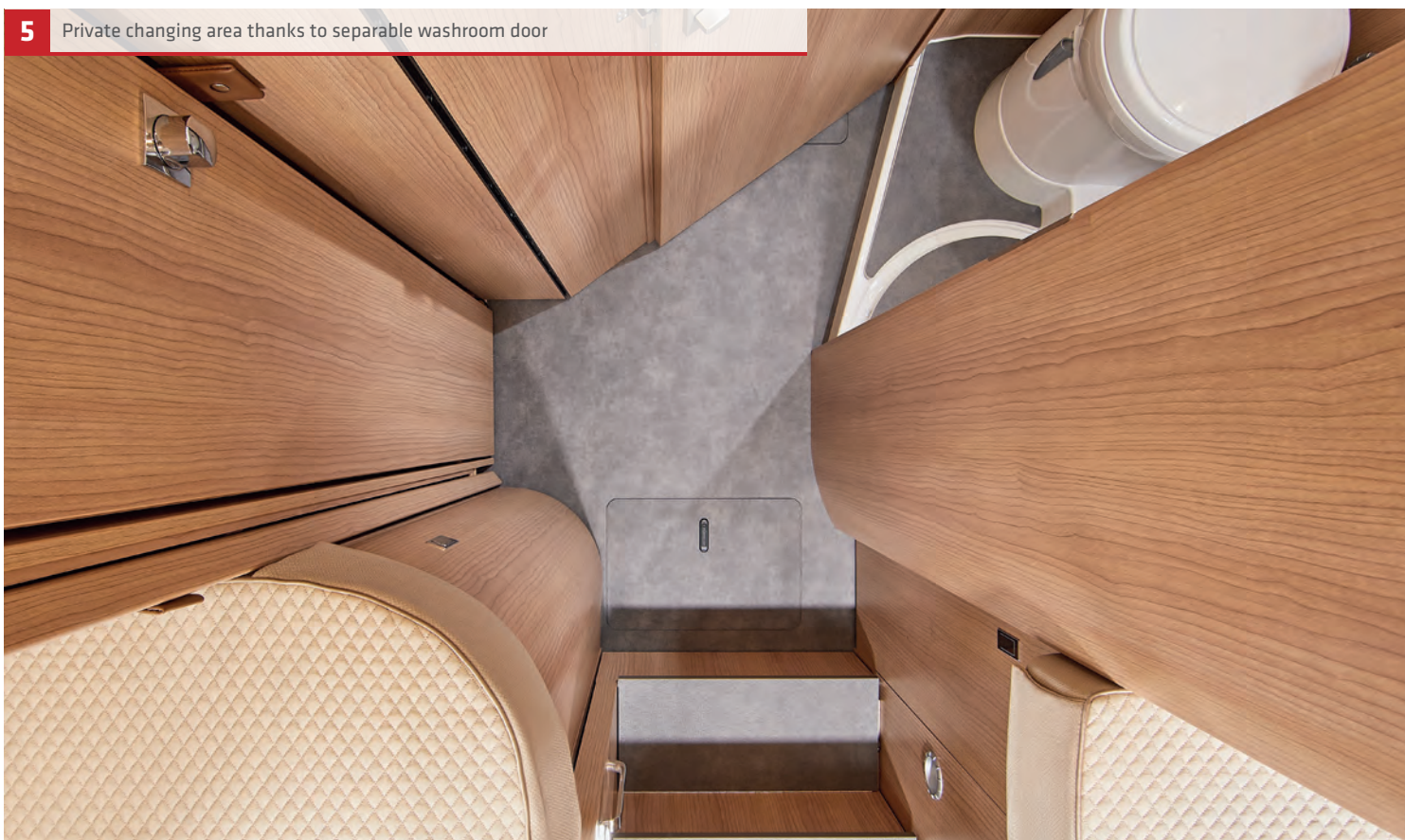

Advantages of the combined washroom:

- 1 Washbasin surface with curved design
- 2 Completely separable round shower with wrap-around doors, shower tray with two drains, practical storage shelves integrated in shower wall and optional, waterproof shower insert in same design as living area floor
- 3 Large wash stand base unit
- 4 Spacious mirror storage cabinet with shelving arrangement, additional shelves and additional mirror next to mirrored storage cabinet
- 5 The washroom door acts as a partition from the living and sleeping areas, creating a private changing room at the same time, optional: solid wood sliding door in the sleeping area provides further room partitioning and therefore a completely separate changing room area (I/T 460 LE)
- 6 Plenty of light and ventilation in the washroom thanks to the Mini-Heki skylight with towel rail

COMFORT LUXURY WASHROOM WITH CHANGING ROOM

Comfort luxury washroom: washroom, toilet and shower room (I/T 490 LE, 500 QB)

Comfort luxury washroom: changing room

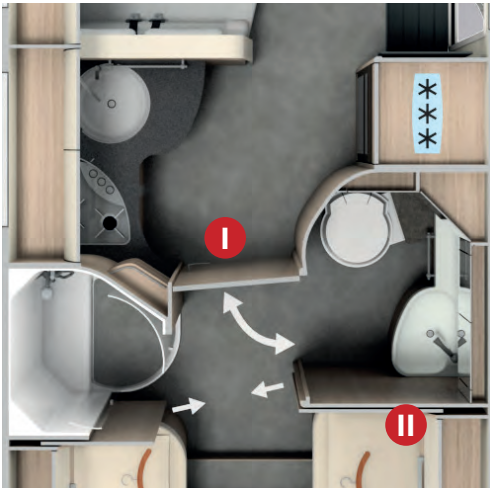

Model I/T 490 LE with lengthways single beds: room partitioning and a changing room that is separated from the living / sleeping area are created in just two steps.

The washroom door **I** also acts as a partition from the living and sleeping areas, creating a private changing room at the same time.

The solid wood sliding door **II** in the sleeping area provides additional room partitioning and therefore a completely separate changing room.



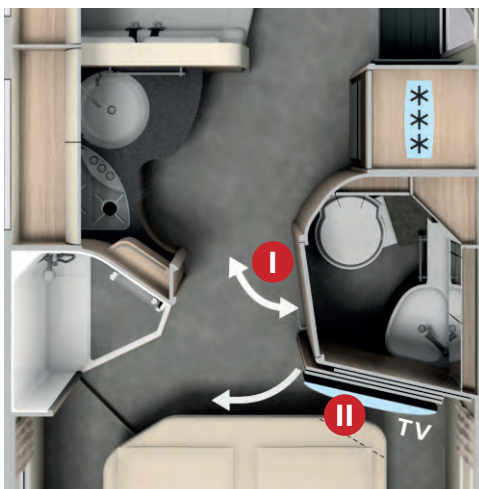

Model I/T 500 QB with queen-size bed: room partitioning and a changing room that is separated from the living/sleeping area are created in just a few steps.

The washroom door ❶ also acts as a partition from the living and sleeping areas, creating a private changing room at the same time.

The pull-out TV wall and room partition ❷ in the sleeping area provides additional room partitioning and therefore a completely separate changing room.

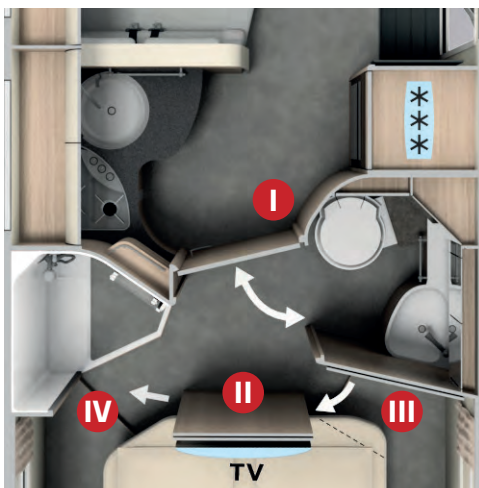

The luxury washroom door ❶ in the living/sleeping area room partitioning position.

The pull-out TV wall and room divider ❷ in the central position for relaxed viewing.

The swivelling wall ❸ and the pull-out sliding element ❹ in the sleeping area provide additional room partitioning and therefore a completely separate changing room.

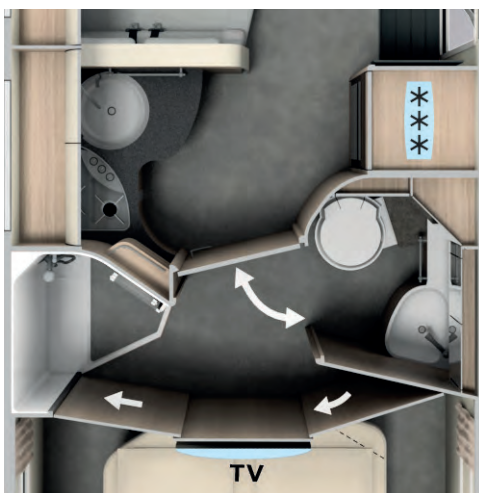

Completely separate changing room with considerable freedom of movement, room partitioning from the living / sleeping areas including central TV position for comfortable viewing.



Comfort luxury washroom advantages:

- 1 Separate washroom and toilet with considerable freedom of movement
- 2 Large shower room opposite washroom and toilet with headroom of 198 cm and level shower access
- 3 Living/sleeping area, solid wood sliding doors in the sleeping area provide further room partitioning and therefore a completely separate changing room area (I/T 490 LE)
- 4 Luxury washroom door provides partitioning from living/sleeping areas, pull-out TV wall and room divider in sleeping area provide further room partitioning and a fully separate changing area as well as flexible positioning of the TV (I/T 500 QB)
- 5 Spacious mirrored storage cabinet with shelving
- 6 Hand towel rail above round shower in roof dome
- 7 Plenty of light and ventilation in the washroom and toilet thanks to the Mini-Heki skylight

4 Completely separable changing room | I/T 500 QB



LENGTHWAYS SINGLE BEDS

(I 441 LE, I/T 430 LE, 460 LE, 490 LE)

1 Lengthways single beds with extra-large bed dimensions and convenient access



2 Wardrobes beneath lengthways single beds





Pull-out comfort access steps



3 Pull-out access steps



3 Optional: pull-out comfort access steps



3 Storage compartment in comfort access steps



4 Floor-to-ceiling wardrobe | I/T 460 LE



Lengthways single bed advantages:

- 1 Extra-large sleeping area
- 2 Wardrobes with additional interior height which can be conveniently accessed from the front and above thanks to the lift function and the divided mattress
- 3 Convenient access to the bed thanks to the pull-out access steps – even when using the additional mattress for extending the sleeping area
- 4 Floor-to-ceiling wardrobe (I/T 460 LE)
- 5 Heated, ventilated slats and 7-zone cold foam mattress for a relaxing night's sleep
- 6 Adjustable head sections
- 7 All-round overhead storage cabinets, also in the rear area

* depending on model

QUEEN-SIZE BED

(I/T 500 QB)



Pull-out TV wall and room divider

1

Luxury washroom door with room partitioning function from living area



1

TV wall in central position for relaxed viewing



1

Room partition with closed swivelling and sliding door for complete room partitioning



2

Large queen-size bed



3

Large drawers beneath bed



4

Fold-away mattress section



Queen-size bed advantages:

- 1 Pull-out TV wall and room divider for variable partitioning of sleeping area from changing room and for flexible TV positioning
- 2 Large queen-size bed with extra-large sleeping area and adjustable head section
- 3 Large drawers beneath bed
- 4 Fold-away mattress section at end of bed for extra-wide passage
- 5 Wardrobes on the left and right of the queen-size bed
- 6 Heated, ventilated slats and 7-zone cold foam mattress for a relaxing night's sleep

DROP-DOWN BED

(Drop-down bed: I 441 LE, 430 LE, 460 LE, 490 LE, 500 QB; Central drop-down bed: T 460 LE, 490 LE, 500 QB)



1 Drop-down bed with extra-large bed dimensions and generous sitting height (A-Class)



2 Optional: electrically operated central drop-down bed

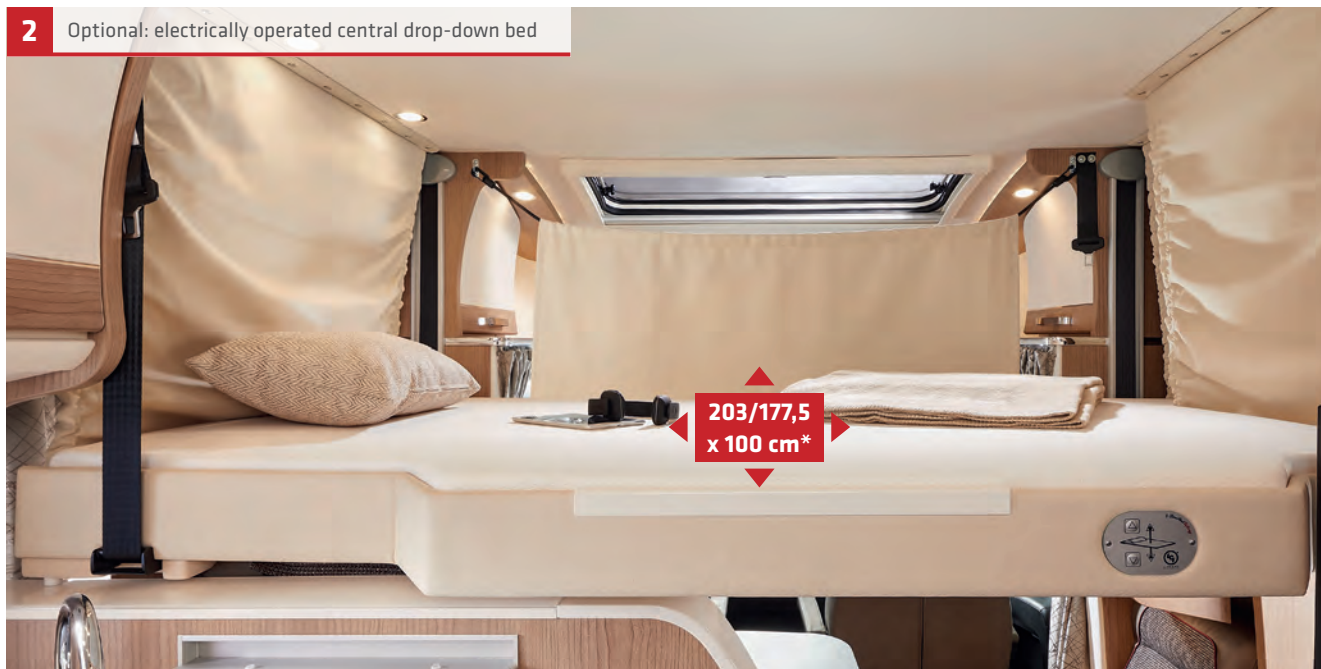

Drop-down bed advantages:

- 1 Extra-large drop-down bed with sleeping dimensions of 195 x 160 cm, generous sitting height of 83 cm, convenient access to bed without ladder using side seat as well as stable bed surface (A-Class)
- 2 Optional: electrically operated central drop-down bed, large sleeping area, headroom of 184 cm beneath the bed (T 460 LE, 490 LE, 500 QB)
- 3 Slatted frame and quality mattress for relaxing sleep
- 4 Extra deep lowering of the bed, therefore more comfortable access via side seat possible (A-Class)
- 5 Wobble-free support in sleeping position, bookshelf and LED spotlights (A-Class)
- 6 Dividing curtain between drop-down bed and living area (A-Class)

* Size dependent on model

MORE MOTORHOME. MORE VALUE. MORE HOLIDAY.

The Carthago Group has been an independent family-run company and permanent feature of the motorhome industry for more than 40 years. Karl-Heinz Schuler, founder and owner, speaks about what makes Malibu motorhomes so unique and the added value which characterises our motorhomes.

Mr. Schuler, when did you decide to work in the caravanning industry?

Karl-Heinz Schuler Camper vans caught my attention on many occasions whilst I was studying. I examined them more closely at the time, and something became clear to me in an instant: we can do better than that! The foundations for Carthago were laid with this idea and motivation. The Carthago Group has successfully established itself on the motorhome market since 1979.

Did you anticipate this success story at the time?

Karl-Heinz Schuler No-one could have known at the time that we would be so successful, nor could it have been planned. Our goal has always been to build the best motorhomes and vans in their respective classes. We want to have satisfied customers. Success and growth then follow naturally.

What is the secret of your success?

Karl-Heinz Schuler The success concept for Malibu motorhomes is our innovative strength, our passion

and our many years of expertise. Behind all of this there is a clear goal: to provide more comfort, more functionality, more quality, more feelgood factor and simply more holiday for our customers. It is particularly important to us to implement every idea and every innovation in practice, and make everyday travelling as pleasant and relaxing as possible for our customers. The Malibu added value runs throughout the entire construction of every single Malibu motorhome.

What does the Malibu motorhome added value stand for?

Karl-Heinz Schuler Our Malibu motorhome added value is our promise of value to our customers, which can be found in every one of our motorhomes and it is motivation and an obligation at the same time. The top class bodywork with elegant roof and side wall rounding, the driver's cabin visibility concept, the high quality furniture construction with double connection technology and the most storage space in its class characterise the Malibu motorhome added value. If the overall concept of a motorhome is right, the holiday will be right too. This is why we're delighted to have been awarded the European Innovation Award 2022 for the GENERATION M motorhomes in the Overall Motorhome Concept category.

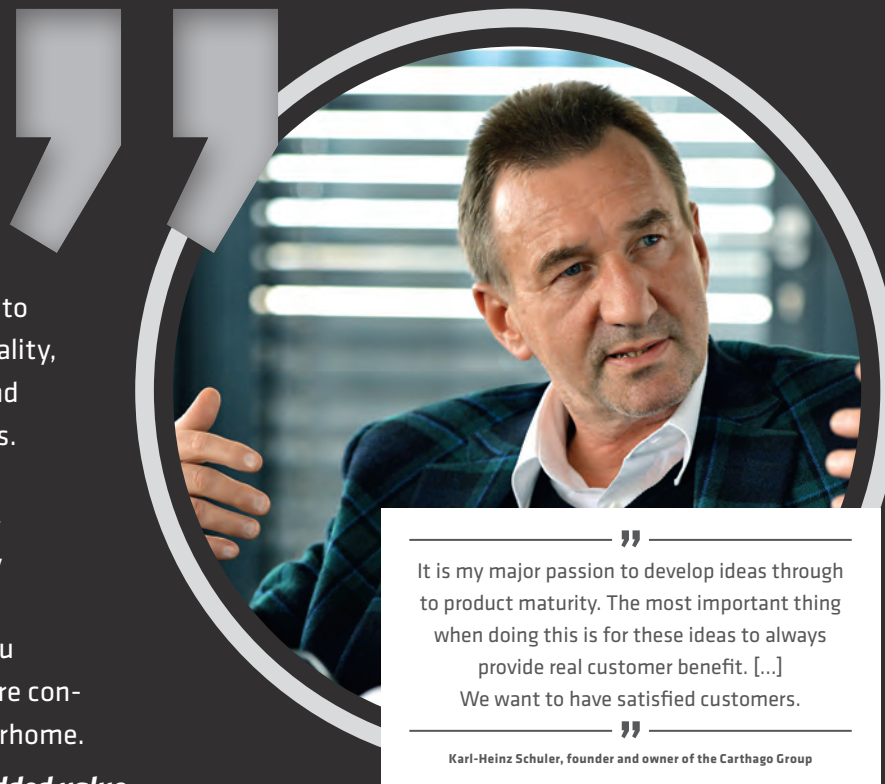

It is my major passion to develop ideas through to product maturity. The most important thing when doing this is for these ideas to always provide real customer benefit. [...] We want to have satisfied customers.

Karl-Heinz Schuler, founder and owner of the Carthago Group

How do Malibu Motorhome drivers benefit from the added value?

Karl-Heinz Schuler Our core competence is providing motorhomes which have that certain something. As that is what makes them unbeatable top class vehicles. Every Malibu Motorhome benefits from our innovative strength, state-of-the-art technology and high quality. We find that only the best is good enough our customers! A Malibu motorhome is a long-term purchase with outstanding value retention. This is because of the quality of the high-tech chassis and the high quality furniture construction with double connection technology, for example. Our customers will have many years of happiness with a Malibu motorhome. I would stake my reputation on it.



Top class bodywork with elegant roof and side wall rounding



Best driver's cabin visibility concept (I)



High quality furniture construction with double connecting technology



Most storage space in its class

TOP CLASS BODYWORK WITH ELEGANT ROOF AND SIDE WALL ROUNDING

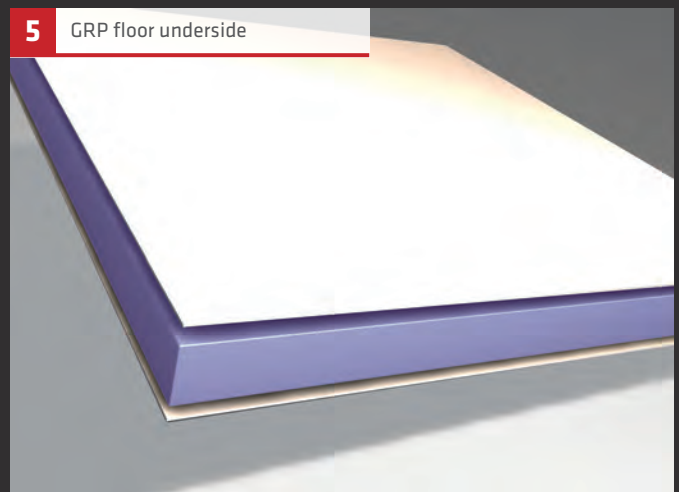
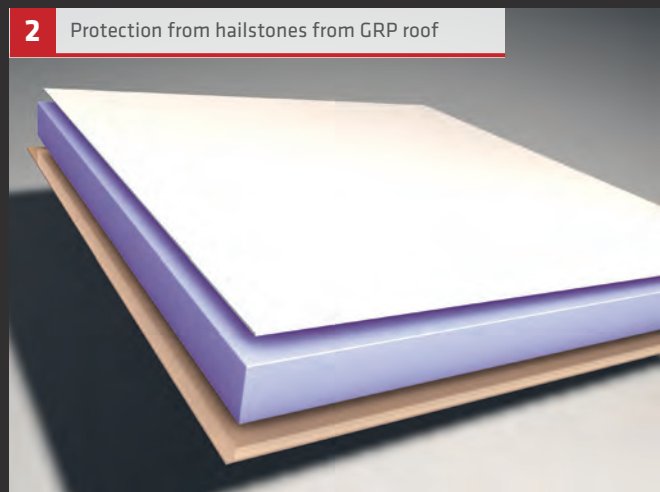
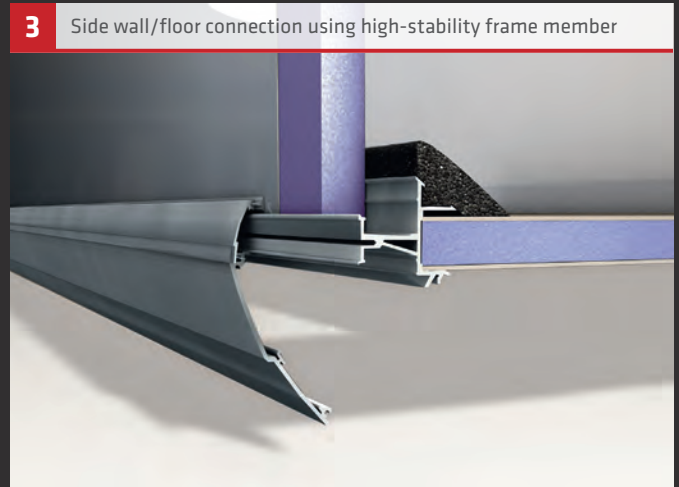

MALIBU HABITATION DESIGN CONCEPT

The Malibu bodywork is consistently oriented to what Malibu drivers want: long-term carefree driving and motorhome value retention. That is why we put our faith in long-term quality – in the high-stability materials that are used as well as the modern processing technology. Instead of the conventional body connection using point-by-point dowel or screw connections, we use an extremely stable and thermal bridge-free connection using form-fitted bonded frame members and PU toothing profiles. An important difference!

	Malibu habitation design	Frequently used standard habitation design
Waterproofing guarantee	10 years ¹	Usually significantly less
Wall structure	Outer wall made from aluminium, hard foam insulating core made from moisture-resistant RTM and water-repellent PU reinforcements	Exterior walls often made from GRP, insulation via water-sensitive EPS foam, wooden frame as connecting / reinforcing element
Roof / wall connection	High-stability frame member, bonded form-fitting with side-on collision protection effect	Roof and wall screwed together point-by-point with sealing tape and covering profile
GRP hailstone and stone impact protection	Standard: roof top and underfloor made from GRP	Wooden underfloor with maintenance-intensive protective coating, roof surface made from hailstone-sensitive aluminium
Attachments	Side skirts made from extruded aluminium profile, segmented into multiple sections. Multi-part rear panel frame and separate rear bumper	Sensitive moulded plastic parts without segmenting, and no separate rear bumper



Advantages of the Malibu habitation design:

- Longevity and therefore good value retention
- Year-round comfort thanks to perfect insulation
- Maximum ride comfort and safety thanks to high-stability body
- Optimum side impact protection
- Protection from hailstones, stone impacts and moisture
- 10-year leak-proof guarantee as standard¹
- Low background noise level while travelling
- Flush-fitted fuel tank flap (A-Class)
- Roof / side wall rounding for elegant overall appearance and maximum main body stability
- Segmented rear and side bumper attachments, easy to repair and therefore affordable replacement in the event of damage
- Extra-secure habitation window frame



MALIBU HEATING AND AIR CONDITIONING EQUIPMENT

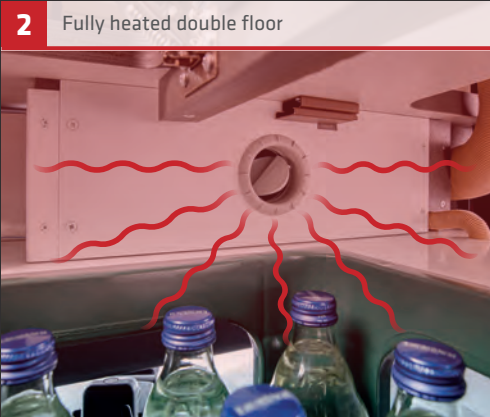
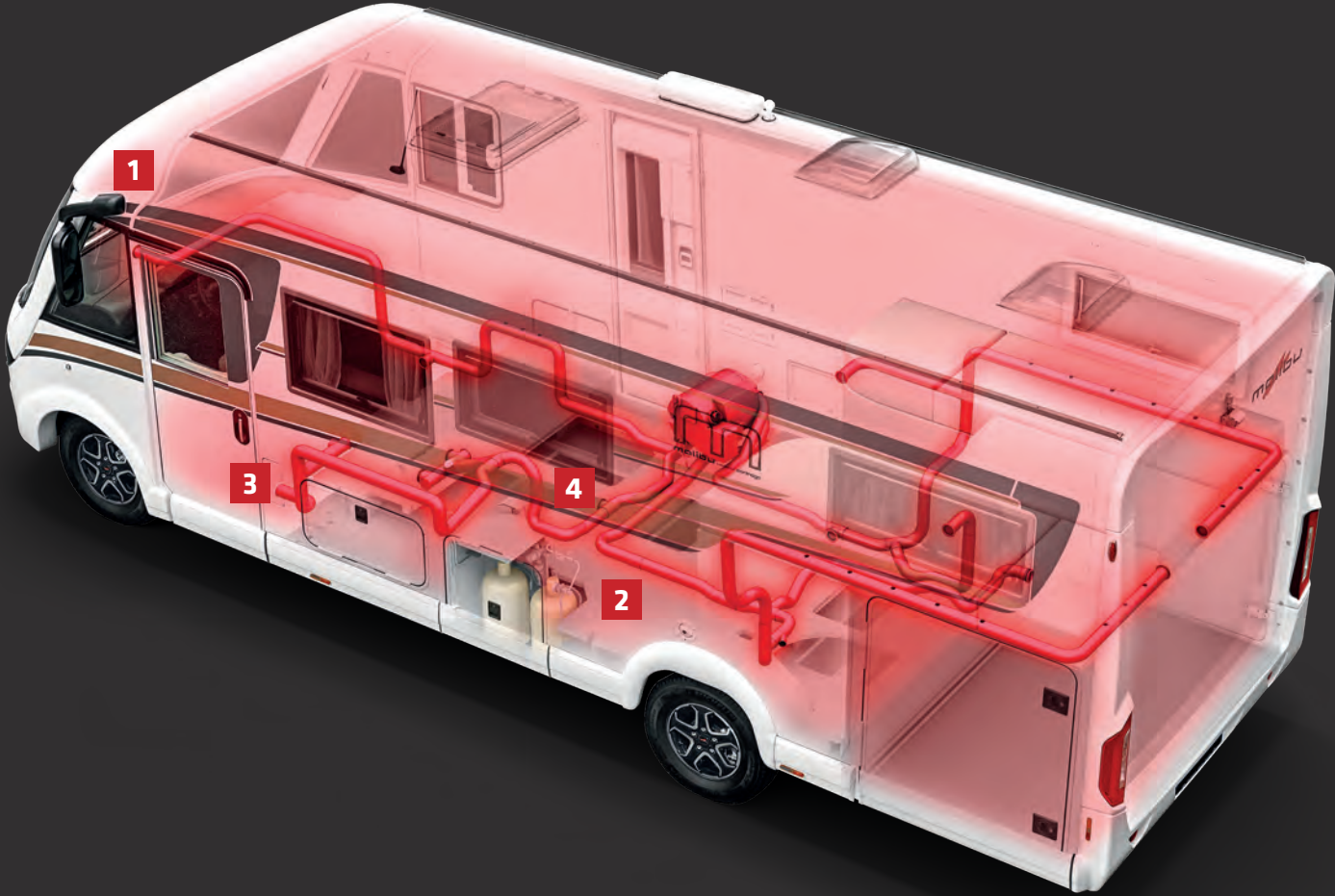

WELL-BEING CLIMATE IN THE MOTORHOME ALL YEAR ROUND!

Is having a good climate particularly important to you when you are on the move? If so, a Malibu motorhome is the perfect companion for you! Regardless of the time of year: you will always have a real feel-good climate in the Malibu. How is that possible? On the one hand, we provide the driver's cabin area, the technical components, the storage compartment and the XL habitation door entrance with targeted heating, and on the other hand the heat circulates through the entire double floor. This means that there is always a pleasant climate inside the motorhome – even at freezing outside temperatures. And vice versa, when it's hot outside, the Malibu is nice and cool. Since that which insulates and heats in winter provides perfect protection from the heat in the summer.

	Malibu heating and air conditioning equipment	Frequently used standard heating and air conditioning equipment
Year-round use	Winter-proof motorhome with year-round comfort	Only "suitable for winter use" or conditionally suitable for comfortable year-round use
Underfloor heating effect	The entire double floor is heated with a climate storage function and underfloor heating effect as standard	No heated double floor, separate underfloor heating required
Heating for cold-sensitive areas	Additional warm air outlets throughout the vehicle, targeted heating of all technical components and cold-sensitive locations	Cold-sensitive areas such as door entrances, tanks and storage compartments often do not have additional targeted heating
Dashboard heating (A-Class)	Dashboard with targeted heating with wide-area heating effect for pleasant heat radiation in driver's cabin	No additional heating for dashboard therefore greater amount of cold radiation from windscreen



The advantages of Malibu heating and air conditioning equipment:

- Winter-proof motorhome with year-round comfort
- Fully insulated double floor, therefore under-floor heating effect
- Highly efficient insulation thanks to high-quality RTM hard foam insulation core, meaning less energy consumption
- Targeted heating of dashboard front for heating the driver's cabin (A-Class)
- Targeted heating of the technical components protects them from frost
- Additional targeted heating of areas that are sensitive to cold such as the storage compartments and the XL habitation door entrance in the living area
- Optional: ALDE warm water heating (I/T 460 LE, 490 LE, 500 QB)
- Malibu Connect Truma iNet X Pro Panel: innovative and digital control panel with central access to all built-in devices and habitation components incl. colour display with touch function, Bluetooth and app control (Touring pack A-Class)



MOST STORAGE SPACE IN THE CLASS THANKS TO THE UNIQUE DOUBLE FLOOR



The storage compartment boxes correspond to the volume of the double floor (depending on model)

YOU CAN NEVER HAVE ENOUGH STORAGE SPACE IN A MOTORHOME!

All Malibu motorhomes provide lots of room thanks to the extra-large double floor and many easily accessible storage compartments, so that your holiday luggage is stowed away safely and neatly in an instant. Bulky luggage such as camping furniture and skis can be stowed away in an optimum way in the central through-loading storage compartment. Thanks to the LED lighting in the through-loading double floor, you always have an overview of your luggage. Your Malibu motorhome is easily and conveniently loaded from the outside via numerous large external hatches. Large, adjustable floor hatches in the living area and the kitchen area provide convenient access to extra-deep low storage compartments from the inside. And the double floor also acts as climate storage to protect your cargo from frost.

	Malibu storage space	Frequently used standard storage space
Double floor type	Double floor along the entire length of the vehicle with a usable height of up to 48 cm	Equipment double floor with limited use of storage space and less usable height
Exterior access	Multiple exterior access points at driver and passenger sides with interior access via L-shaped lounge seating area and side seat bench	Few or no exterior access points, no interior access to the exterior storage compartments possible
Through-loading function	Central through-loading storage compartment over the entire vehicle width in front of the XL habitation door	No through-loading function due to lack of exterior access points or storage compartment that is not continuous
Interior access	Two huge, lowered living area floor hatches in the entrance and kitchen area incl. high quality hinges	No interior access, storage compartment contains equipment and can only be used to a limited extent
Weight balance	Thanks to the huge amount of storage space and multiple access locations, the weight can be distributed in an optimum way during loading	Limited amount of storage space and access options only allow even weight distribution to a limit extent



Advantages of the double floor:

- Double floor with huge, heated storage compartment, usable height up to 48 cm
- Access from the exterior via several large hatches
- Large, central through-loading space (interior height 17 cm) with extra-deep double floor storage compartment (usable height 39 cm), also easy to load through the XL habitation door via a large, self-supporting living area floor hatch
- Interior access via the L-shaped seating area and the swing-up (I 490 LE, 500 QB) or lift-up side seat bench (not I 441 LE)
- The entire double floor is heated with a climate storage function and underfloor heating effect as standard
- LED lighting in through-loadable double floor

MOST STORAGE SPACE IN THE CLASS

1 Large, heated double floor storage compartment

(usable height up to 48 cm) with central through-loading area (interior height 17 cm)

2 Huge living area floor hatch in entrance area, also easy to load

from the outside with the main XL entrance door is open, second living area floor hatch in kitchen area (usable depth of up to 39 cm)

3 Convenient loading of double floor storage compartment at drivers side via another large external hatch.

Interior access via L-shaped seating area, swing-up (I 490 LE, 500 QB) or lift-up side seat bench (not I 441 LE) as well as via large living area floor hatch in entrance and kitchen area

4 Malibu scooter garage

- Large interior height, plenty of room for E-bikes, motorized scooters or bicycles. Load capacity up to 250 kg
- Lowered loading edge for convenient loading
- Garage floor with robust GRP covering prevents slipping and damage
- Two standard garage doors for access from both sides and easy loading and unloading
- With lighting, heating and frost-proof insulation
- Lashing rails at both sides with flexibly positionable lashing eyes for easy securing and loading

5 Large additional double floor storage compartment with

separate exterior hatch



Usable height up to 48 cm



Gas bottle compartment



Scooter garage,
load capacity up to 250 kg



Optional Malibu Pedelec
scooter garage for queen-
size bed model I/T 500 QB

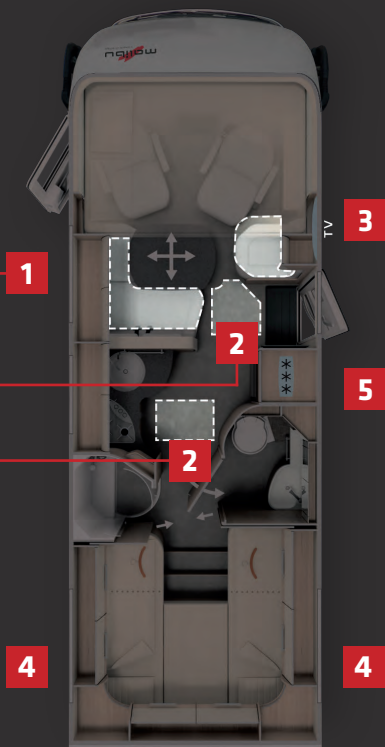
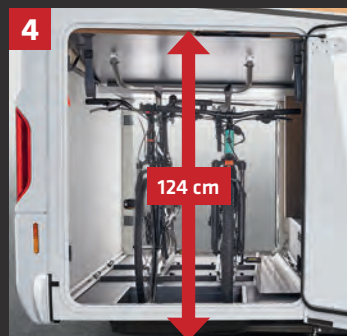

MALIBU PEDELEC SCOOTER GARAGE

(Optional for I/T 500 QB)



Pedelec scooter garage with
interior height extension

Will your big bike or Pedelec not fit into the rear garage of your motorhome? That's no problem with Malibu – even with queen-size bed models I/T 500 QB. Malibu has developed a Pedelec solution especially for the requirements of queen-size bed models. Wonderfully simple, simply wonderful – how it works: just push up the queen-size bed from the outside with a single manual operation, slide the bike into the garage using the optional ramp system, and lower the queen-size bed again. The Malibu trick: the front wheel of the bike slots into a recess in the floor. Everything securely lashes down – ready to go. The recess in the floor and the underside of the bed, which can be pushed upwards, create a loading height of up to 124 cm. If no bicycles are being transported, the recess in the floor is covered with a floor panel, creating a level loading surface. Inside in the sleeping area, the queen-size bed remains at its low, conveniently accessible height.



1 Easy loading thanks to optional ramp system



2 Loading height extension



3 Optional transport anchoring system



4 Cover panel for floor lowering



Malibu Pedelec scooter garage advantages

- 1 Optional ramp system for convenient loading and unloading of bikes
- 2 Interior height extension of the Pedelec garage from 112 cm to 124 cm
- 3 Optional transport fixing system makes secure anchoring possible while travelling
- 4 Cover panel for floor recess, therefore also usable as a level loading surface
- 5 Bike with handlebar height of up to 124 cm can be transported, no unloading required for sleeping
- 6 Queen-size bed in sleeping area with low and convenient bed access
- 7 Innovative solution with simple operation

HIGH QUALITY FURNITURE CONSTRUCTION WITH DOUBLE CONNECTION TECHNOLOGY

1 Double connection technology

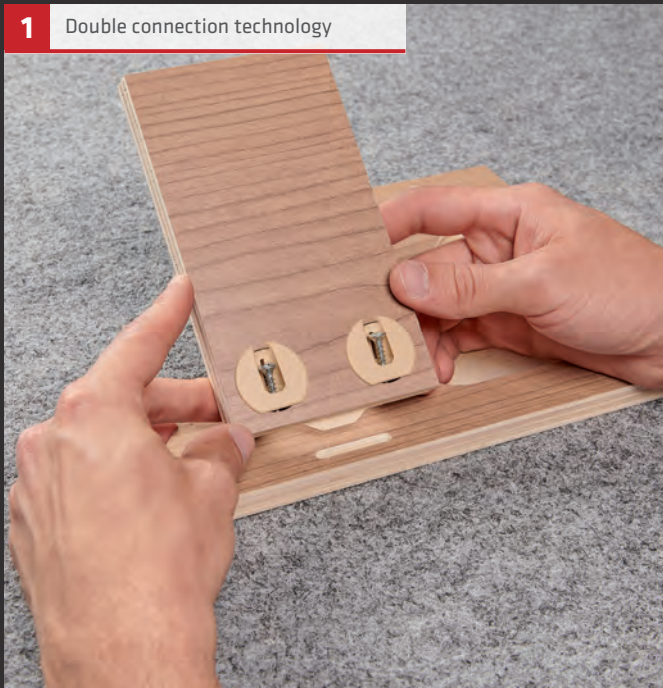

2 High-quality hinges

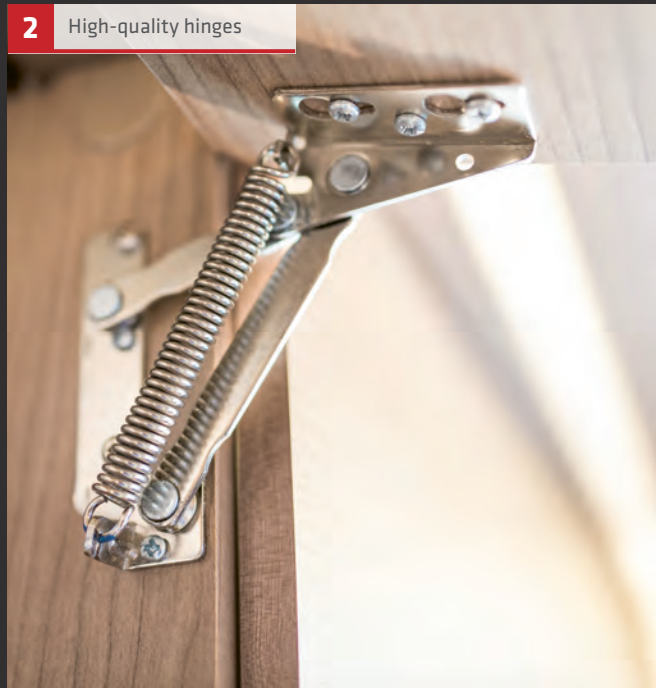

3 Roller-mounted drawers with self and soft closing mechanism



4 Door handles in household quality



5 Spacious overhead storage cabinets with intermediate panel



6 "Modernline" furniture design





7 Underlighting with LED lighting technology



8 Curved kitchen worktop



Advantages of high-quality furniture construction with double connection technology:

- 1 Double connection technology: the furniture is screwed together and also mortised – for maximum stability and longevity
- 2 High quality, robust metal hinges
- 3 High quality, roller-mounted kitchen drawers with self and soft closing mechanism
- 4 Door handles and fittings in household quality
- 5 Spacious overhead storage cabinets with intermediate panel and microfibre lining for reducing the noise level while travelling
- 6 “Modernline” furniture design with concave curved storage cabinet flaps with modern avant garde design for a particularly spacious feeling
- 7 Elegant under-lighting of kitchen worktops and floor lighting in the seating area and kitchen area for a cosy atmosphere*
- 8 Elegant and practical at the same time: curved kitchen work surface for visual partitioning of the living and kitchen area and as additional storage space*

	Malibu furniture construction	Frequently used standard furniture construction
Furniture connection	Double connection technology - screwed and also mortised for maximum stability and long lasting furniture construction	Mainly just screw simple connections, screws of furniture components often visible
Hinges and fittings	High quality and robust metal hinges, washroom doors with internal hinges, door handles and fittings in household quality	Low-cost plastic hinges and fittings as well as exterior hinges on washroom doors
Noise level while travelling	Low noise levels while travelling thanks to high quality furniture construction (e.g. felt coverings on all furniture connections), hinges in household quality and microfibre covering in the overhead storage cabinets	Significant noise generation while travelling due to lack of noise reduction measures in the furniture design

* depending on model

BEST DRIVER'S CABIN VISIBILITY CONCEPT AMONG THE A-CLASS MOTORHOMES

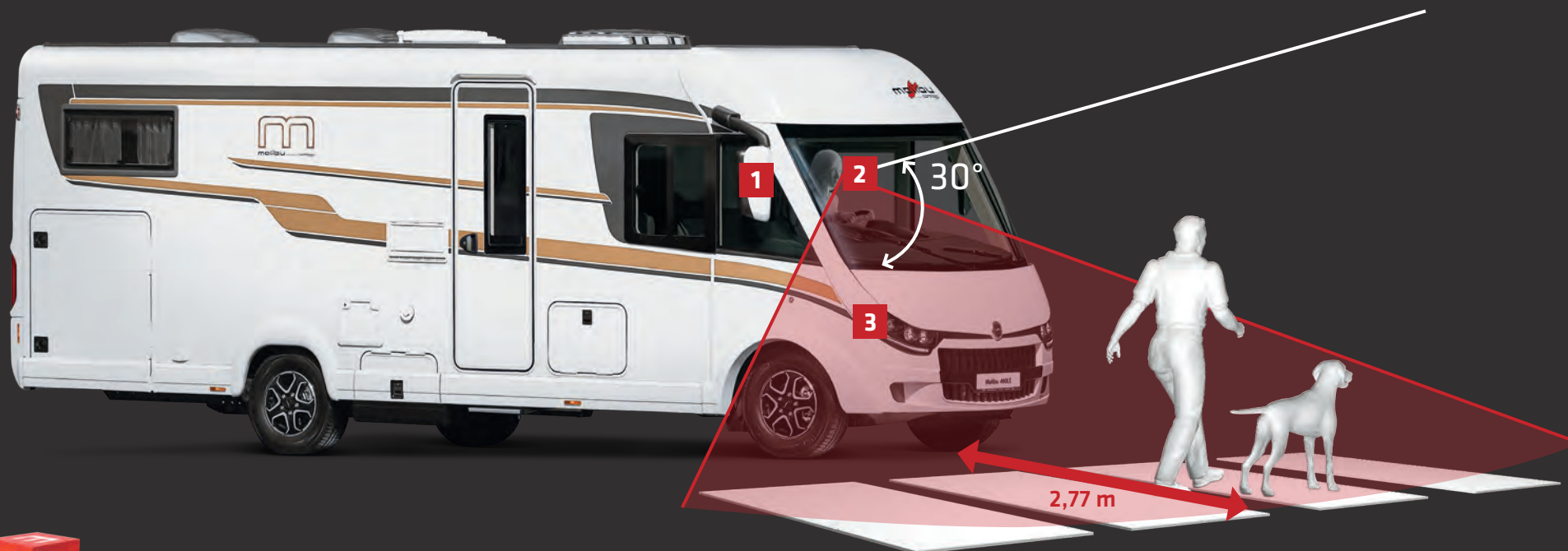

Advantages of the driver's cabin visibility concept:

- 1 Best all-round visibility thanks to rear-view bus mirror with large main mirror and wide-angle wing mirrors
- 2 Optimal overview in driving position thanks to active driving, extra-low dashboard for early visibility of the road as well as the deep panoramic windscreen
- 3 LED daytime driving lights

Malibu visibility concept: view of road surface after just 2.77 m (l).
Competitor models often only achieve this after 4 to 5 m.

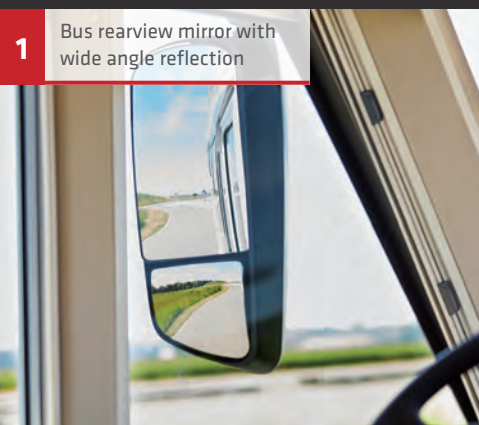

1 Bus rearview mirror with wide angle reflection



2 Extra-deep recessed dashboard



3 LED daytime driving lights

MALIBU INTERIOR



Worlds of living



London (Standard)
Fabric combination



Paris (Standard)
Quilted fabric combination



Lisbon (Standard)
Antara fabric combination



Rome (Standard)
Antara fabric combination



Santorini (Standard)
Antara fabric combination



Ancona (Optional)
Textile leather / fabric combination

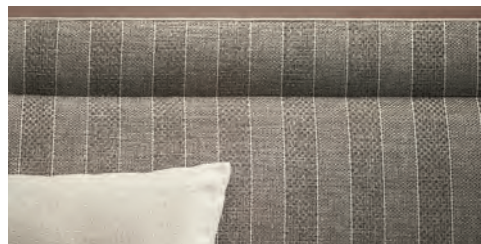

Palermo (Optional)
Textile leather / fabric combination



Ivory part leather (Optional)
Leather / fabric combination

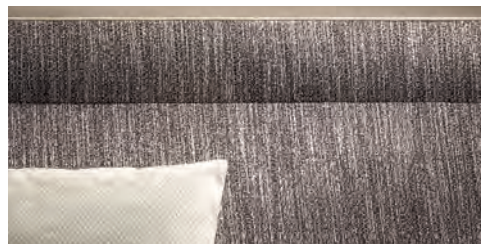

Chestnut part leather (Optional)
Leather / fabric combination

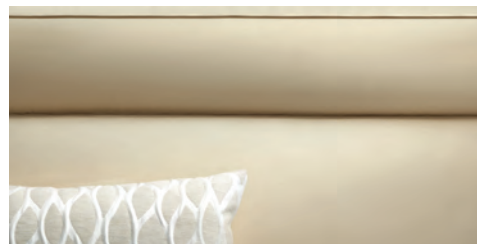

Ivory Leather (Optional)

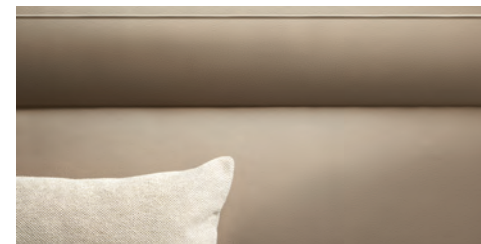

Macchiato Leather (Optional)

Colour differences from the original are possible for typographical reasons. To make your selection, ask your dealer partner for their sample book.

MALIBU INTERIOR AND EXTERIOR



Bellagio world of style



Overhead storage cabinet front panels: high gloss ivory with wooden strips and chrome piping



Overhead storage cabinet bottom: Matt ivory



Table and worktop decor: Shale look



PVC base: Graphic Stone

Alloy wheels



Optional: 16" alloy wheels for Fiat Ducato f35 light chassis



Optional: 16" alloy wheels for Fiat Ducato f40 heavy chassis / f35 light chassis in conjunction with automatic transmission



Advantages of the Malibu interior:

- Living area upholstery with highly effective stain protection: fluids do not penetrate into the fabric. The majority of stains can be easily wiped off with a damp cloth
- Living area upholstery is hard-wearing and easy to look after
- Washable curtains and decorative cushion covers
- Antibacterial mattress cover
- Hard-wearing PVC floor covering
- Excellent anti-fade properties

Optional: Malibu world of sleeping & decoration set with up to three decorative cushions (depending on model), a Jacquard bed throw with woven-in Malibu logo and a fitted sheet set to match the respective model

MALIBU TEST & RENT: ENJOY A TEST DRIVE



The Malibu sales exhibition in Aulendorf and many of our trade partners give you the opportunity to rent vehicle – be it for a one-time holiday experience or for initial familiarisation. The optimum solution for anyone who is considering purchasing a Malibu vehicle. We would be pleased to advise you and look forward to seeing you!



Malibu table and chair set

consisting of two camping chairs with Malibu logo and a table, incl. practical carry bag.

Discover our Malibu motorhomes
on our social media channels:



More information about Malibu can be found at
www.malibu-motorhomes.com

© Malibu GmbH & Co. KG | Carthago Ring 1 | 88326 Aulendorf | Germany
Tel. +49 (0)7525 / 9200-0

Changes may occur during the model year after the editorial deadline for this printed document in July 2022. The manufacturer reserves the right to make structural and design changes that become necessary, provided they are in the interest of technical progress and are reasonable for the customer, plus changes to equipment, differences in colour combinations or individual colour shades, material quality differences and changes to the scope of delivery on the part of the manufacturer. This also applies to colour differences on basic vehicles, insofar as they are a result of changes made by the basic vehicle manufacturer. Please consult your dealer for detailed advice concerning the status of the current product or series.

The information about the scope of delivery, appearance, performance, dimensions and weights of the vehicles (differences within the scope of the factory tolerances (+/- 5% max.) are possible and permissible) corresponds to the state of knowledge at the time of going to print. Please be aware that some of the vehicles are depicted with special equipment for which an additional charge applies. In some cases they are shown with equipment features that do not correspond to the series production version and are also not available as special equipment. The decoration depicted in the catalogue is not a constituent of the scope of delivery. More technical information can be found in the price list.

Reprinting of this document, or even extracts thereof, is only permitted if written authorisation is obtained from Malibu GmbH & Co. KG beforehand. The information in this publication is compliant with the German StVO and StVZO (road traffic and road traffic licensing regulations). No liability accepted for errors and/or misprints.

¹ Please note the Malibu warranty conditions

Printed in Germany



malibu
a company of carthago